

Ventilation Plugs Polyamide

Ventilation plugs

- Balances pressure differences between inner housing and the outside environment.
- Prevents damages according to pressure differences.
- Prevents the formation of water condensation in tightly-sealed standard housings.
- Membrane properties: hydrophobic, oleophobic.

Technical Details

Body	PA 6 (Polyamide 6)	
Material	Acrylic co-polymer on nylon-support	
O-Ring	NBR (standard for A , D and E types)	
Gaskets	NBR (standard for B , J and F types)	
Ingress Protection Rating	IP 68 / IP 67 (for water intrusion pressure 0.1 bar) IP 69K (only for D type)	
Flammability	V2 according to UL94	
Operating Temperature	Permanent	Intermittent
	-40 °C to +100 °C	-45 °C to +150 °C
Thread Type	<ul style="list-style-type: none"> • Metric EN 60423 • without thread 	
Accessories	<ul style="list-style-type: none"> • Lock nuts 	
Remarks	<ul style="list-style-type: none"> • Some approvals do not cover all colours or sizes. 	

Approvals	Certificate Number	Standards
	E350312	UL508A UL50E CAN/CSA C22.2 No.14-2010
TYPE 4X		

For details of approvals, see our website.

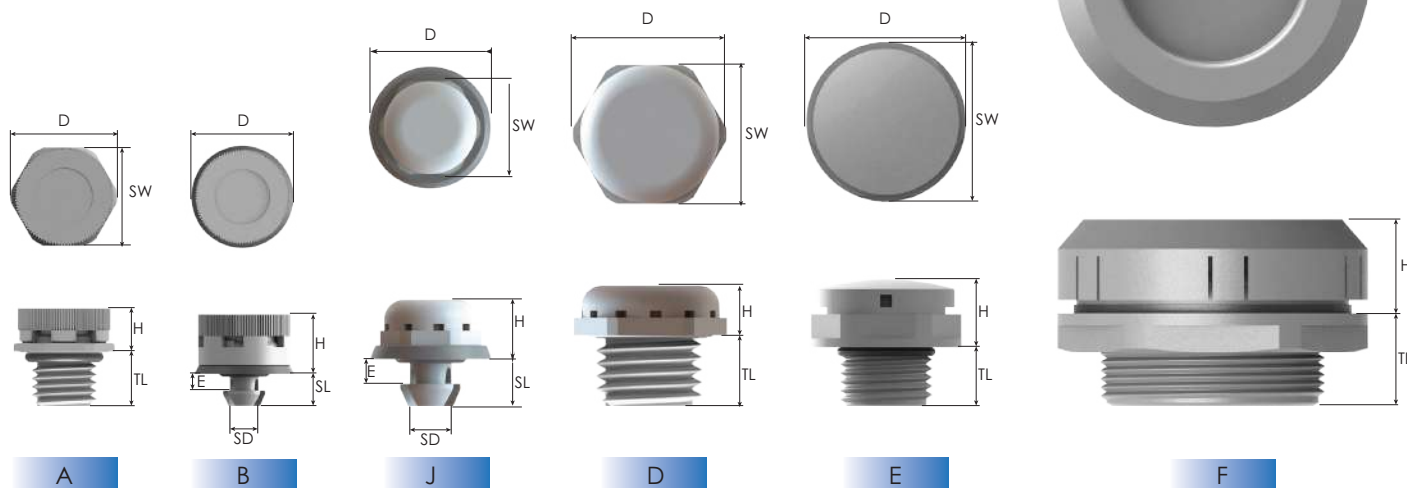

Hole Details for B and J Type Snap-Fit Ventilation Plug

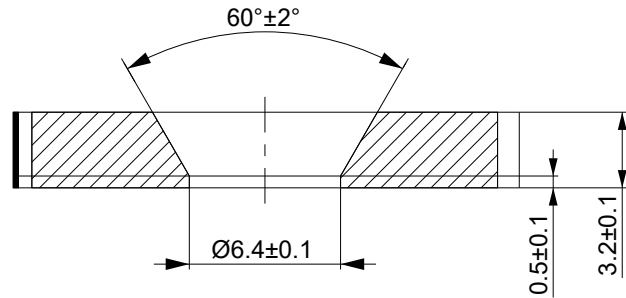

Ventilation Plugs Polyamide

Thread Type METRIC acc. to EN 60423											
Outer Thread Size (Male)	Average Air Flow for $\Delta P = 70$ mbar/1 psi	Water Intrusion Pressure	Outer Thread Length	Spanner Width	Outer \varnothing		Height	Design Type	Part Number		
					TL mm	SW mm			D mm	H mm	RAL 7035 light grey
M6x0,75	8	0,5	10,0	10	11,0	6,15	D	MBVPG-11	MBVPG-01	MBVPG-21	
M8x1,0	15	0,5	10,0	12	13,0	6,15	D	MBVPG-12	MBVPG-02	MBVPG-22	
M12x1,0	16	0,9	6,6	17	18,5	7,6	A	SBVPA-11	SBVPA-01	SBVPA-21	
	25	0,5	6,6	17	18,5	7,6	A	MBVPA-11	MBVPA-01	MBVPA-21	
	120	0,2	6,6	17	18,5	7,6	A	HBVPA-11	HBVPA-01	HBVPA-21	
	300	0,1	6,6	17	18,5	7,6	A	UHBVPA-11	UHBVPA-01	UHBVPA-21	
M12x1,5	25	0,5	10,0	17	18,8	6,15	D	MBVPG-13	MBVPG-03	MBVPG-23	
	16	0,9	6,0	17	18,5	7,6	A	SBVPB-11	SBVPB-01	SBVPB-21	
	16	0,9	10,0	17	18,5	7,6	A	SBVPB-11L	SBVPB-01L	SBVPB-21L	
	25	0,5	6,0	17	18,5	7,6	A	MBVPB-11	MBVPB-01	MBVPB-21	
	25	0,5	10,0	17	18,5	7,6	A	MBVPB-11L	MBVPB-01L	MBVPB-21L	
	42	0,9	10,0	24	26,0	11,7	E	SBVPD-11	SBVPD-01	SBVPD-21	
	120	0,5	10,0	24	26,0	11,7	E	MBVPD-11	MBVPD-01	MBVPD-21	
	120	0,2	6,0	17	18,5	7,6	A	HBVPB-11	HBVPB-01	HBVPB-21	
	120	0,2	10,0	17	18,5	7,6	A	HBVPB-11L	HBVPB-01L	HBVPB-21L	
	300	0,1	6,0	17	18,5	7,6	A	UHBVPB-11	UHBVPB-01	UHBVPB-21	
	300	0,1	10,0	17	18,5	7,6	A	UHBVPB-11L	UHBVPB-01L	UHBVPB-21L	
	450	0,2	10,0	24	26,0	11,7	E	HBVPD-11	HBVPD-01	HBVPD-21	
750	0,1	10,0	24	26,0	11,7	E	UHBVPD-11	UHBVPD-01	UHBVPD-21		
M16x1,5	42	0,9	10,0	24	26,0	11,7	E	SBVPF-11	SBVPF-01	SBVPF-21	
	120	0,5	10,0	24	26,0	11,7	E	MBVPF-11	MBVPF-01	MBVPF-21	
	450	0,2	10,0	24	26,0	11,7	E	HBVPF-11	HBVPF-01	HBVPF-21	
	750	0,1	10,0	24	26,0	11,7	E	UHBVPF-11	UHBVPF-01	UHBVPF-21	
M20x1,5	42	0,9	10,0	24	26,0	11,7	E	SBVPE-11	SBVPE-01	SBVPE-21	
	120	0,5	10,0	24	26,0	11,7	E	MBVPE-11	MBVPE-01	MBVPE-21	
	450	0,2	10,0	24	26,0	11,7	E	HBVPE-11	HBVPE-01	HBVPE-21	
	750	0,1	10,0	24	26,0	11,7	E	UHBVPE-11	UHBVPE-01	UHBVPE-21	
M40x1,5	120	0,9	18,0	-	55,3	15,5	F	SBVPX-18S	SBVPX-08S	SBVPX-28S	
	375	0,5	18,0	-	55,3	15,5	F	MBVPX-18S	MBVPX-08S	MBVPX-28S	
	1350	0,2	18,0	-	55,3	15,5	F	HBVPX-18S	HBVPX-08S	HBVPX-28S	
	2200	0,1	18,0	-	55,3	15,5	F	UHBVPX-18S	UHBVPX-08S	UHBVPX-28S	

wall thickness (E) : 3,2 mm											
Snap Size	Average Air Flow for $\Delta P = 70$ mbar/1 psi	Water Intrusion Pressure	Snap		Outer \varnothing	Spanner Width	Height	Design Type	Part Number		
			Length SL mm	\varnothing SD mm					D mm	SW mm	H mm
Snapfit 5,5	16	0,9	5,9	5,4	18,5	-	10,9	B	SBVQ-M11	SBVQ-M01	SBVQ-M21
	25	0,5	5,9	5,4	18,5	-	10,9	B	MBVQ-M11	MBVQ-M01	MBVQ-M21
	120	0,2	5,9	5,4	18,5	-	10,9	B	HBVQ-M11	HBVQ-M01	HBVQ-M21
	300	0,1	5,9	5,4	18,5	-	10,9	B	UHBVQ-M11	UHBVQ-M01	UHBVQ-M21
wall thickness (E) : 3,2 mm											
Snapfit 5,5	15	0,5	5,9	5,4	15,0	12	7,8	J	MBVPGQ-12	MBVPGQ-02	MBVPGQ-22
	25	0,5	5,9	5,4	18,5	17	7,8	J	MBVPGQ-13	MBVPGQ-03	MBVPGQ-23